

CHL W 6,3XL

Vite per cemento testa bombata

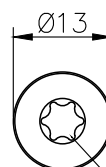
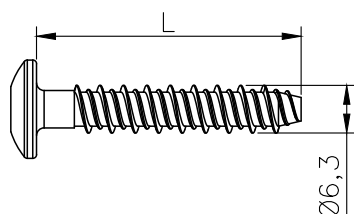

Torx 30
Prof 2-2,4

MATERIALE: Acciaio C18
TRATTAMENTO: Cementato
RIVESTIMENTO: Geomet 321

SCALA: 1:1
FIRMA: Alberto B. T.
DATA: 07/05/2020



**Rottura
in Trazione**

20500 N

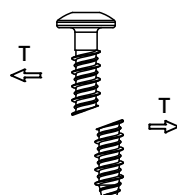

**Rottura
al Taglio**

14000 N

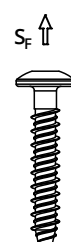

**Sfilamento da CLS
foro Ø 5 mm**

Rck	30	50
ins. (mm)		
25	-	4000 N
30	3500 N	5000 N

N=Newton 1N ~ 0.102 kgf - I valori indicati rappresentano il valore caratteristico derivante dalle diverse sessioni di prove